

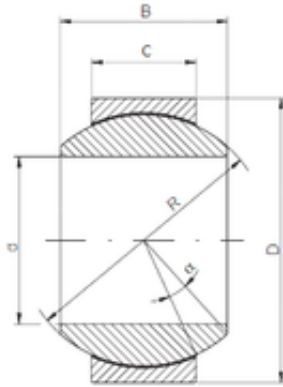

Bearings International Co., Ltd

ISO GE 060 HCR-2RS plain bearings



Bearing No. GE 060 HCR-2RS

Size	60x105x63 mm
Bore Diameter	60 mm
Outer Diameter	105 mm
Width	63 mm
d	60 mm
D	105 mm
B	63 mm
C	40 mm
R	92 mm
Angle	17 °

GE 060 HCR-2RS Bearing 2D drawings and 3D CAD models